

# FALLS RESERVE Conservation Area



911 Address:  
80900 Falls Reserve Line,  
Benmiller, ON

## Legend

- Designated Parking Area
- Garbage and Recycling Centre
- Gatehouse/Registration Office
- Wastewater Dumping Station
- Fishing; Fishing Pond
- Horseshoes
- Pavilion
- Picnic Shelter
- Picnic Tables
- Radio Free
- Swimming
- Volleyball Court
- Park Entrance
- Privy
- Washroom/Showers
- Picnic Rental Areas
- Potable Water-tap
- Park Boundary
- Campground Paths
- Steep Slope
- Restricted Area (No Public Access)

**ALL DOGS MUST BE LEASHED  
AND KEPT ON THE TRAILS**

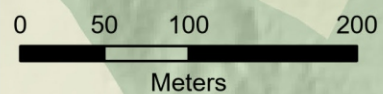

### Maple Campground

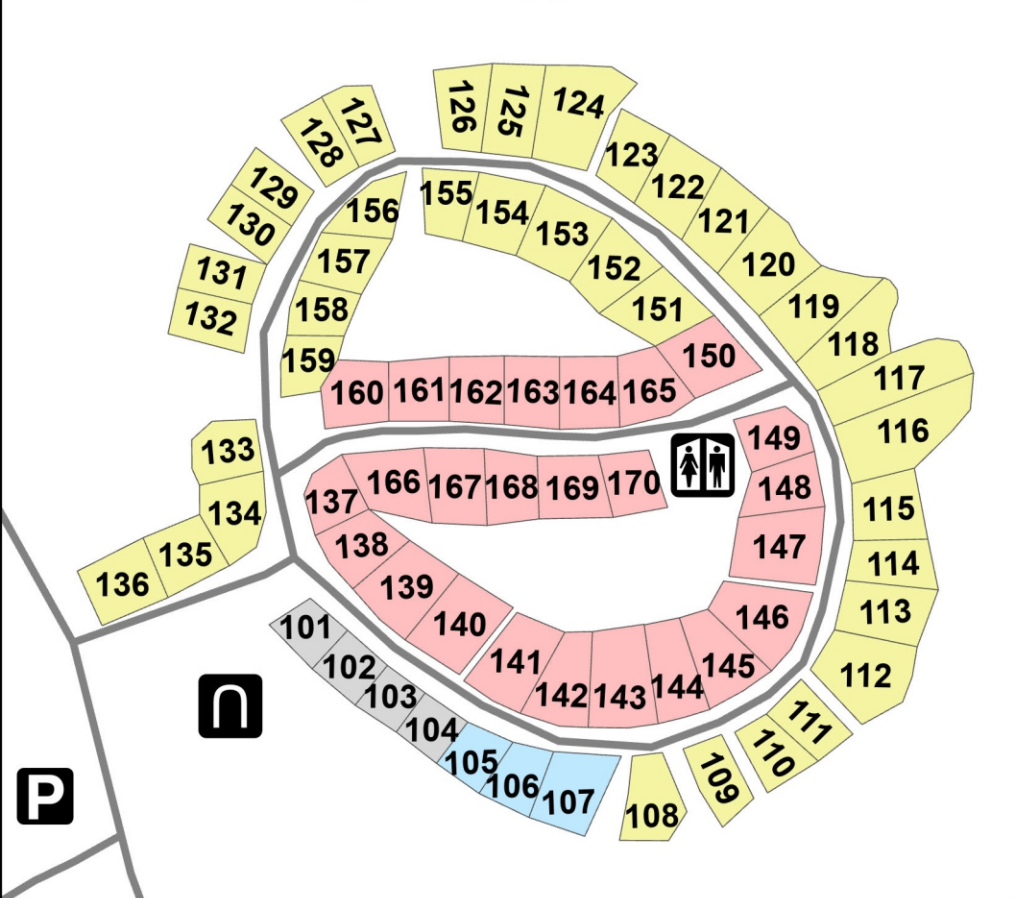

### Cedar Campground

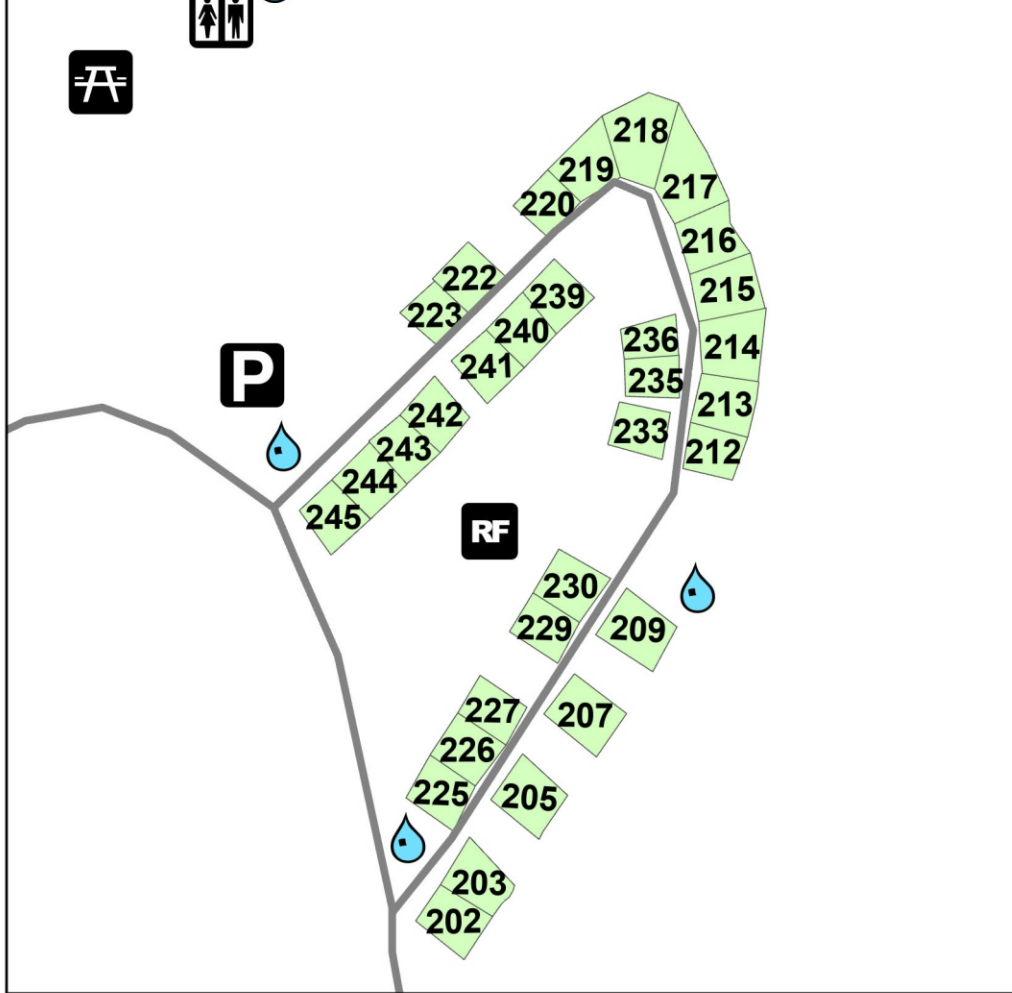

### Sycamore Campground

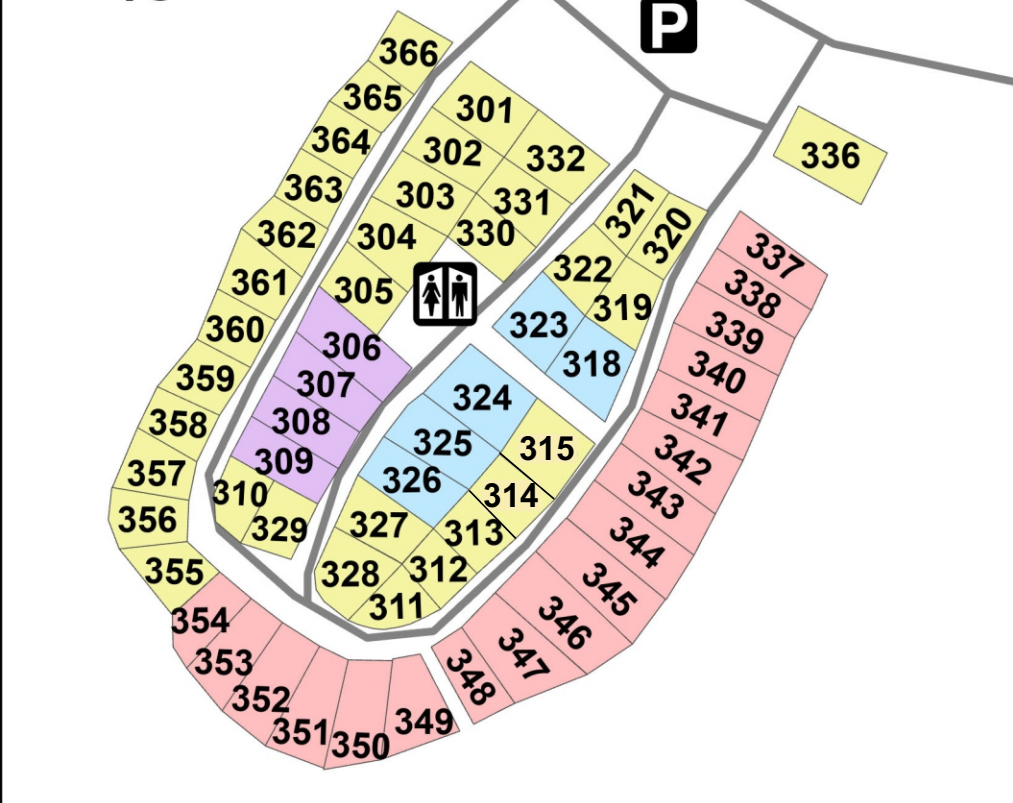

### Secluded Tent Campground

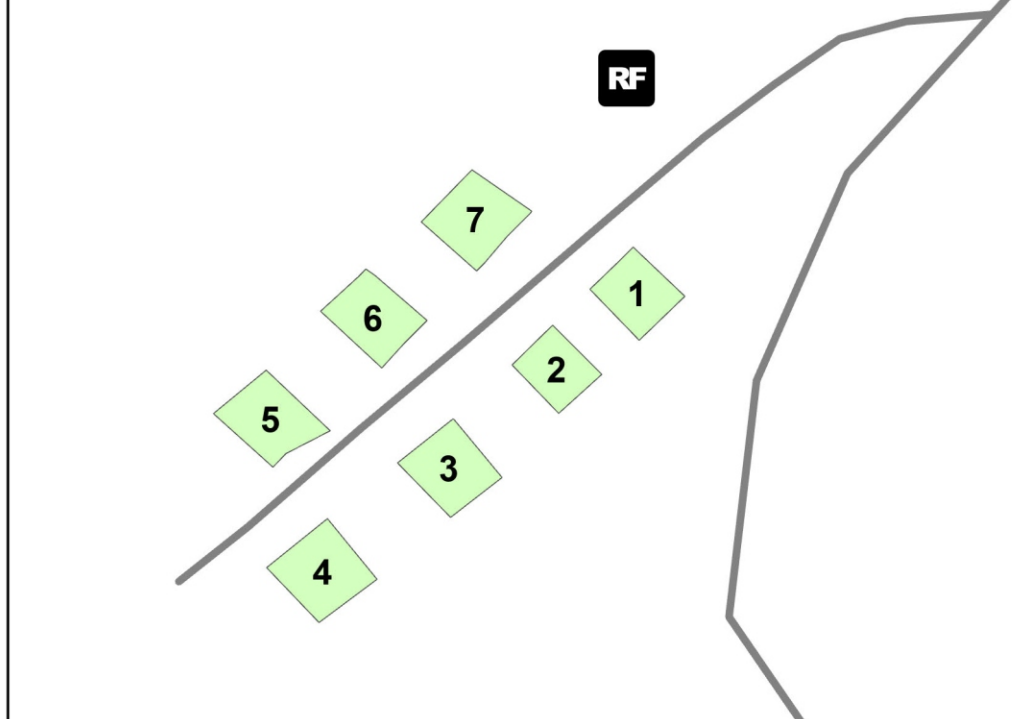

### Legend

- Washroom/Showers
- Designated Parking Area
- Horseshoes
- Picnic Tables
- Radio Free
- Potable Water-tap
- 30 Amp, Water Hook Up
- 30 Amp, Water Hook Up, Pull Thru
- 30 Amp, Water & Sewer Hook Up
- 30 Amp, Water & Sewer Hook Up - Seasonal
- 50 Amp, Water & Sewer Hook Up
- Radio Free Camping Sites - Non-Serviced

### EMERGENCY PHONE NUMBERS

Park Office: 519-524-6429 Park Security: 519-525-6315  
**Police, Fire, Ambulance: 911**  
 Goderich Hospital: 519-524-8323  
 Clinton Hospital: 519-482-3447  
 Poison Information Centre: 1-800-268-9017

**Immediate Assistance:** In the event of a life-threatening or serious injury dial 911. Have someone meet emergency responders at the park entrance and direct them to the situation. After calling 911, it is **very important** that you contact the Gatehouse at 519-524-6429. Staff are required to follow up on any situation where police, emergency medical services or hospital services have been required in the park. Please keep us informed!

**Park Address:** Falls Reserve Conservation Area, 80900 Falls Reserve Line, Benmiller, ON

**Nearest Intersection:** Londesborough Rd. (County Rd. #31) and Lucknow Line (County Rd. #1)

### Severe Storm Emergencies

If a severe weather warning is issued, bring everyone in your party together and seek shelter in a safe, secure area. Washroom buildings would be considered a safer place to seek shelter. **DO NOT** seek shelter from a tornado in your tent, mobile trailer or vehicle. If you're not able to get to a washroom building, seek shelter in a low lying area away from hazards such as overhead power lines and trees. After the storm, staff will assess any personal injuries, hazards and damages and take necessary actions. Contact staff or tune into local radio stations for weather forecasts or potential storm threats.

### First Aid and Emergencies

First aid kits for the treatment of minor cuts and scrapes are located at the Gatehouse, the park office and in each park vehicle. Trained staff can provide basic first aid on request. For serious accidents, staff will provide assistance and put you in touch with professional care.

**Radio Stations:** FM 104.9 Goderich, FM 101.7 Wingham, FM 94.5 Wingham, FM 95.5 Kincardine, AM 920 Wingham