

# Lock Box Instructions

## Firearm safety

Instructions on how to use and secure your firearm lock box.

### How to set the combination on the dial lock

1. First, set the numbers on the dial to your three-digit combination ('000' for first use) and turn the black knob to the right to open the box.



2. With the box open, find the silver metal tab on the backside of the locking piece.
3. Move the metal tab from 'A' to the 'B' as shown in the picture. You may need to use the cap of a pen or another device to help you move the tab.
4. Set the new 3-digit code and then move the metal tab back to the 'A' position to set your code.
5. To test that the new code has been set, keep the safe open, turn the black knob on the front to the left. Change the numbers on the dial to a combination that is not the one you chose and see if you can turn the knob to the right. If you cannot turn the knob to the right, then you know that your new combination set. You may reset your combination as many times as you like.

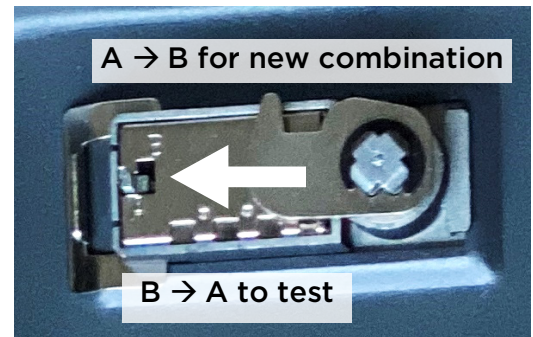

1 of 3

### To Learn More

- Injury Prevention  
206-987-6197
- Ask your child's healthcare provider
- [seattlechildrens.org](http://seattlechildrens.org)

### Free Interpreter Services

- In the hospital, ask your nurse.
- From outside the hospital, call the toll-free Family Interpreting Line, 1-866-583-1527. Tell the interpreter the name or extension you need.



**Seattle Children's**  
HOSPITAL • RESEARCH • FOUNDATION

## Lock Box Instructions

---

### How to lock and unlock the lock box

After you set a new combination, you can lock your firearm securely in the lock box.

1. Place your unloaded firearm in the lock box and close the lid. It is safest when your firearm is stored locked and unloaded with the ammunition locked in a separate location.



2. Turn the knob to the left to lock.
3. Scramble the numbers until they no longer match your chosen combination.

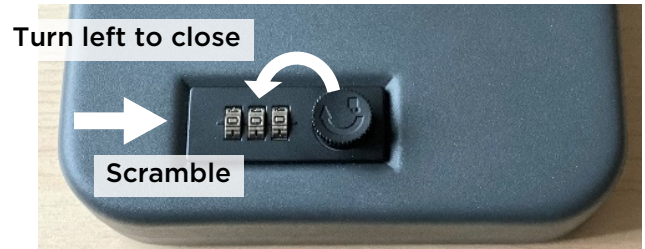

4. To unlock, set your combination and turn the knob right.

---

### How to secure the lock box using a cable

To use a cable to secure your lock box:

1. Wrap the cable around a heavy or immovable item to make sure your box is secure in one place.



2. Pull the knob end through the looped end

## Lock Box Instructions

---

3. With the lock box open, insert the knob end into the notch on the left side of the box.
4. Close the box and lock it.



---

### Additional resources:

To learn more about firearm safety, visit our webpage at: [seattlechildrens.org/firearmsafety](https://seattlechildrens.org/firearmsafety)

Check out our How to Use Firearm Locking Devices Video: [youtu.be/1JB7CfALePM?si=ay\\_rCSOf06NJXdNV](https://youtu.be/1JB7CfALePM?si=ay_rCSOf06NJXdNV)

